

GAME VRYBURG

NORTH WEST:
VRYBURG

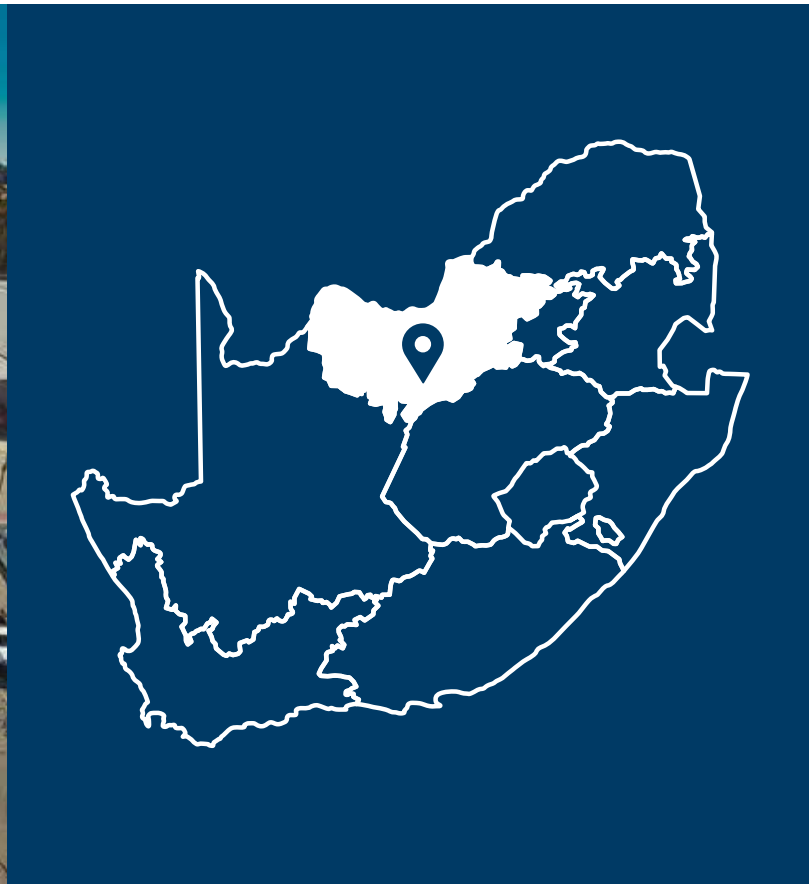



ABOUT VRYBURG

Vryburg is a large agricultural town with a population of 48,200 situated in the Dr Ruth Segomotsi Mompati District Municipality of the North West Province of South Africa. It is centre and the industrial and agricultural heartland of the district of the Bophirima region. The town is situated halfway between Kimberley (the capital of the Northern Cape Province) and Mahikeng (the capital of the North West Province). From Vryburg, there are roads, rail and air connections to all the major centers in the country. Vryburg is also situated on the main railway line from Cape Town to Botswana and Zimbabwe. It is South Africa's largest beef-producing district, with Bonsmara cattle the most popular.

ABOUT GAME VRYBURG

Game Vryburg is anchored by an excellent and well trading Game store, with Clicks as co-anchor, the only of it's kind in a radius of 200km plus. The balance of the tenant offering is composed of relevant and sought after convenience and clothing brands such as Woolworths Textile and Mr Price Clothing. The centre has ample free and open parking with a KFC drive through at its entrance. A strong characteristic of this development is the four ATM's located on-site offering visitors access to all major banks [FNB, ABSA, Standard Bank, Capitec]. It is located on a major road linking Gauteng, the North West and the Northern Cape provinces. The building has clear visibility and enjoys firm community support.

GAME VRYBURG

FAST FACTS



Vryburg Population

48 200



Distance to Johannesburg
Distance to Upington
Distance to Kimberley

353km
407km
205km

BUILDING FAST FACTS



13 Total retail stores



196 Free parking bays



Direct and easy access



Ample free parking



Part of busiest retail district in Vryburg



Situated on a main thoroughfare road



7 028m² GLA



GAME VRYBURG

ADDRESS

Game Vryburg Shopping Centre,
Market Street, Vryburg, 8601

26°57'24.9"S 24°43'44.1"E

ANCHOR TENANTS



WOOLWORTHS

JOHANN KLOPPER

Asset Manager

Cell: +27 (0)83 259 7468

Tel: +27 (0)12 361 7970

Email: johann@moolmangroup.co.za



LOCALITY MAP

POINTS OF INTEREST

- 1 Gert Lubbe Stadium 1.1km
- 2 Vryburg Private Hospital 1.9km

SCHOOLS

- 3 Vryburg High School 500m
- 4 Colinda Secondary School 2km
- 5 Colinda Primary 2.3km
- 6 Floradene Primary School 2.3km



SITE LOCATION & ORIENTATION

POINTS OF INTEREST

- 1 Suidwes Landbou Vryburg 120m
- 2 Vryburg Magistrates Court 400m
- 3 Taxi Rank 650m
- 4 SAPS Vryburg 650m

OTHER RETAIL

- 5 Vryburg Cash & Carry 190m
- 6 Shoprite Vryburg 350m
- 7 Food Town Hyper 450m
- 8 Cashbuild 800m
- 9 Vryburg Boxer Superstore 900m



TENANT LIST

GAME VRYBURG

- Shop 1 Game
- Shop 2 Studio 88
- Shop 3 Johan Craig
- Shop 4 Boesmanland Biltong
- Shop 5 King Pie
- Shop 6 Clicks
- Shop 7 Hafeez General Dealer
- Shop 8 Eye Catchers
- Shop 9-11 Mr Price
- Shop 12 Woolworths
- Shop 13 Sheet Street

ATM

- Nedbank
- FNB
- Standard Bank
- ABSA Bank

- KFC drive – through

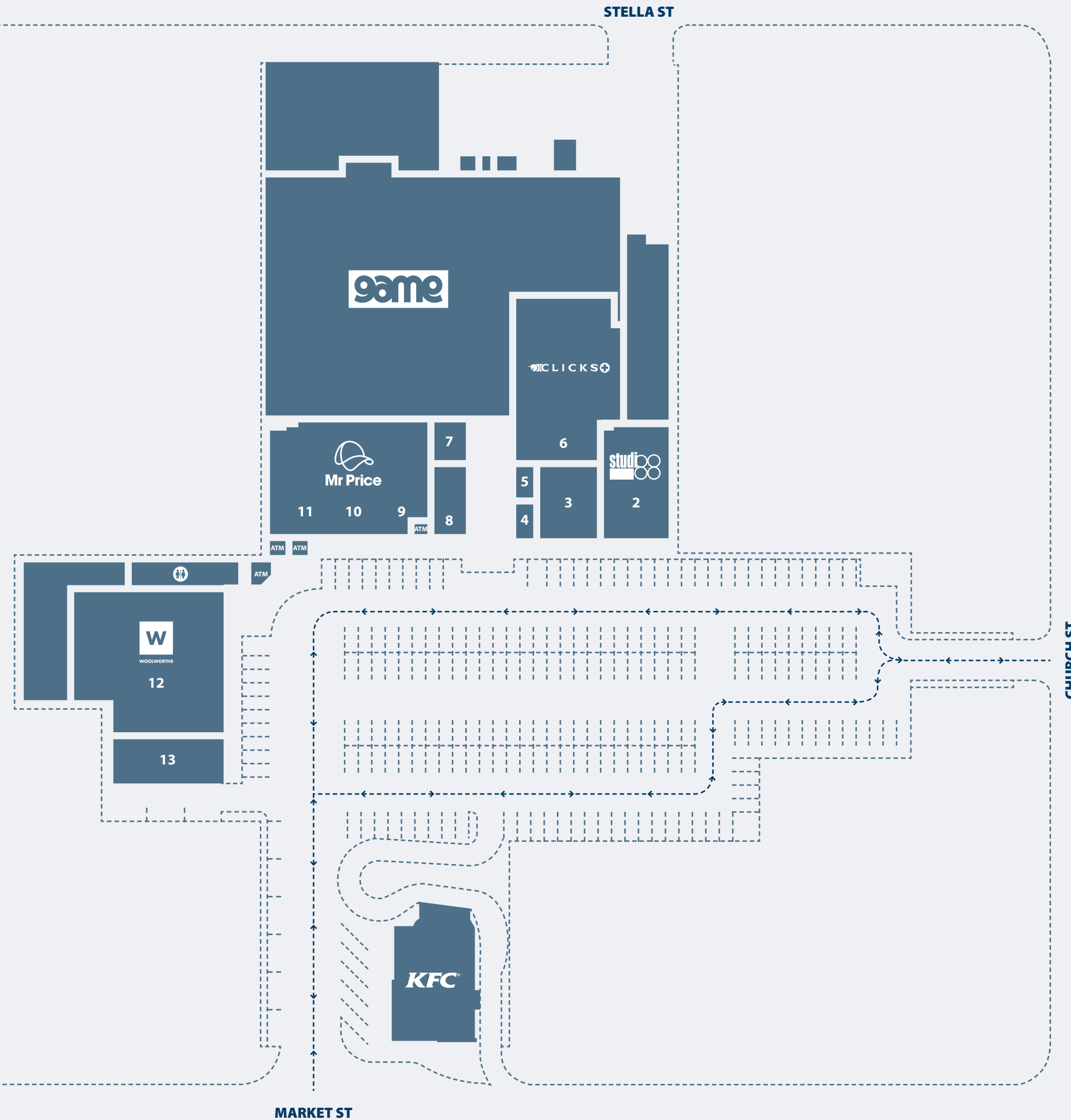

GAME VRYBURG

LEASING ENQUIRIES:

FOR MORE INFORMATION PLEASE CONTACT:

JOHANN KLOPPER

Asset Manager

Cell: +27 (0)83 259 7468

Tel: +27 (0)12 361 7970

Email: johannk@moolmangroup.co.za



moolmangroup

OUR NAME PRECEDES US

EST. 1967

www.moolmangroup.co.za